



**NEO**

**MASTER**

**EXPERT**

New generation of PTI spot welders

# A NEW GENERATION OF PTI DESIGNED FOR ALL VEHICLES AND ALL APPLICATIONS

After the worldwide success of the GYSPOT PTI-s7, GYS decided to undertake a new challenge: **design a range of modern spot welders, drawing on our world-leading experience and the latest advances in technology.**

By combining power, usability and advanced traceability, these spot welders set a new standard for spot welding.



PTI NEO



PTI MASTER



PTI EXPERT

WELDING CURRENT: 14 000 A		14 500 A
SUPER INTUITIVE COLOR DISPLAY		
LIGHTWEIGHT, MOBILE AND PRACTICAL		MACHINE WITH BALANCING SYSTEM
CLASSIC CLAMP	MANUAL OVER-OPENING CLAMP	
THE LIGHTEST CLAMP IN THE WORLD (WITH G1 ARM)		
21.38 lb	22.71 lb	26.01 lb
COMPATIBLE G ARM, A GYS EXCLUSIVE		

# INTUITIVE COLOUR DISPLAY

All 3 spot welders feature the new, ultra-intuitive 3.5” full-colour control interface. Designed to optimize machine set-up time, menu navigation is fluid, and incorporates animations to assist the user at every stage of the welding process.

Traceability and updates made easy via USB port.

Multilingual interface, as easy to use as your smartphone.

2 buttons for quick and easy menu access.

Central thumbwheel to easily navigate menus and set parameters.

# AUTOMATIC MODE EASY TO USE

The machine instantly detects workpiece thickness, the type of steel and if there is any adhesive present, and calculates the exact amount of time, current and clamping force required for a successful weld at each point.

0 settings / 0 errors  
100% reliable spot welding





# PTI NEO & MASTER

## LIGHTWEIGHT, MOBILE & PRACTICAL

With a space-saving footprint, the PTI **NEO** (125.66 lb) and **MASTER** (127.87 lb) are the ideal solution for workshops where space is at a premium. The clamps on these models are very light (21.38 lb and 22.71 lb), so they can be supplied without a balancing system.

- Compact and space-saving.
- **Lightweight, easy-to-move trolley.**
- Fast access to your different arms via a storage rack (max. 8 arms).
- Delivered in a box for easy storage and transport (31.50 x 23.62 x 27.56 inches).



# LIGHTWEIGHT, INNOVATIVE CLAMP

The lightweight clamp simplifies the work of the user and reduces physical strain. The ability to change arms quickly, together with a wide selection of G-arms, ensures easy and convenient access to all areas of the vehicle body.



- Perfect electrical contact through a unique brass connection system based on a dovetail concept.
- **Quick, automatic arm set-up.** Mechanical adjustment of the arm on the clamp takes place automatically, without user intervention. The service life of electrical contact elements is greatly extended. The user also benefits in terms of efficiency and speed.



# PTI EXPERT

## INTEGRATED BALANCING SYSTEM, MAXIMUM COMFORT

The PTI **EXPERT** differs from the other 2 machines in that it has a higher gait factor, which means it can be used more intensively, and also thanks to its 360° rotating clamp (gyroscope) and its stem, for greater comfort and precision.

- The arm supports the weight of the clamp while offering freedom of movement and an optimised working position.
- The gyroscope makes it easy to position the clamp in difficult areas.
- The 196.85" balancing system offers greater access to vehicle parts/areas without having to reposition the machine.



# INSULATED G-ARMS

## A COMPREHENSIVE RANGE

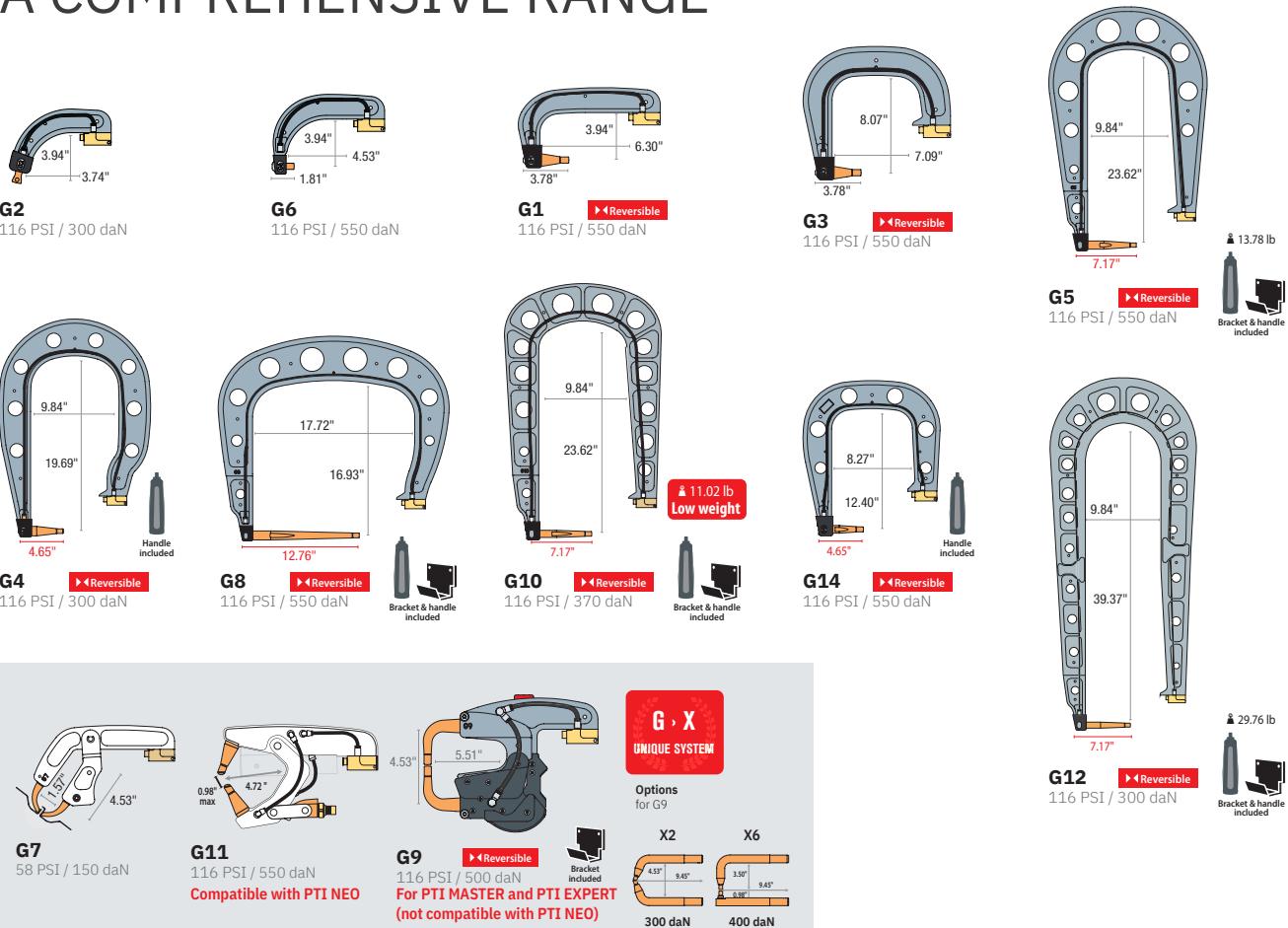



# MANUAL OVER-OPENING CLAMP

The manual over-opening, with 2.95 Inch clearance, is a GYS-patented innovation that considerably improves ergonomics and efficiency for vehicle body specialists.

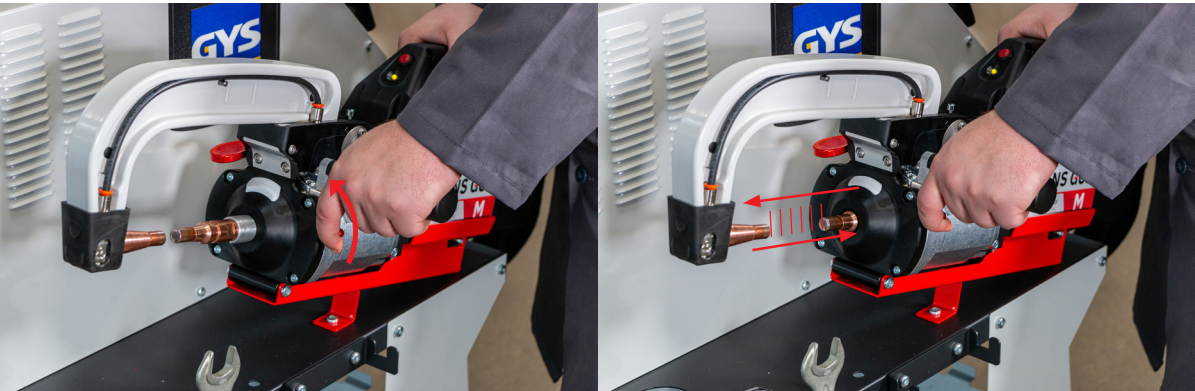

1 Lever operation

2 Electrode retraction

This feature, available on the PTI **MASTER** and **EXPERT**, greatly facilitates access to the welding area.

- Enhanced access to challenging bodywork areas.
- Better visibility and precision when positioning electrodes.
- Saves time by reducing the number of more complex procedures.



## Clamp features

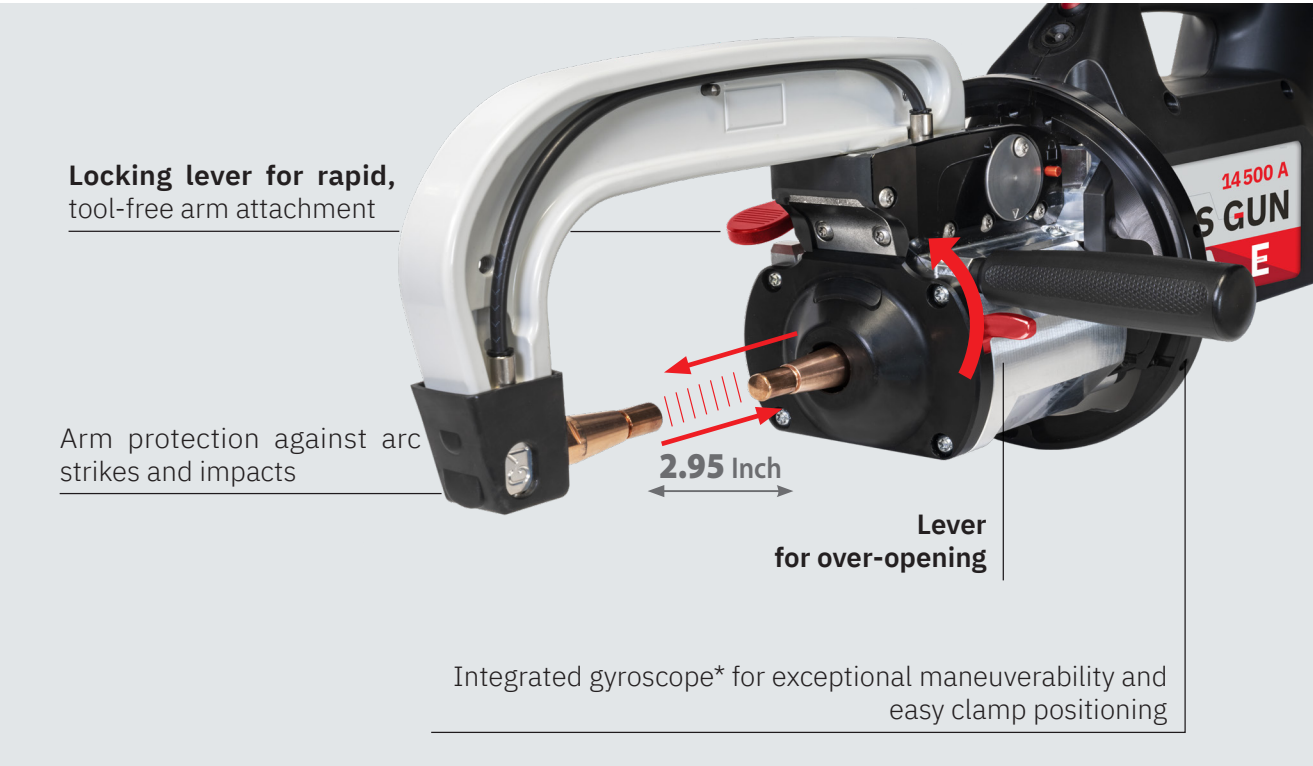

\*PTI **EXPERT** only

# SINGLE-POINT GUN

## ULTRA-VERSATILE SOLUTION

The 3 spot welders can be fitted with a single-point gun (Quick-Fixing kit, ref. 082823). This optional accessory is designed specifically for dent removal and car body repair.

Quick and easy connection to the machine, with no need for complex adjustments or tools:



Dedicated storage on the machine



Connecting the control cable from the gun to the clamp



Quick and easy gun installation

### • Welding for dent removal:

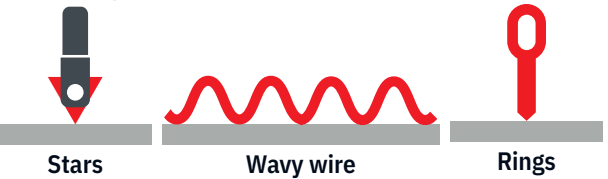

### • Sheet metal work:



Impact reduction / Shrinking (graphite pencil)



- Compact and ergonomic, ideal for working on localized damage.



# SPECIFICATIONS TECHNICAL

	PTI NEO	PTI MASTER	PTI EXPERT
Power supply (3-phase)	208 - 240 V	208 - 240 V	208 - 240 V
Part numbers	with G1	077362	083257
	complete	084841 (G1+G2+G4)	087972 (G1+G2+G4+G9)
Fuse	30 A	30 A	50 A
Tank volume	1.32 Gal  (liquid not included)		7.93 Gal   (liquid not included)
Power supply cable	314.961 Inch		
Dimensions	24.80 x 29.92 x 50 Inch		26 x 39.37 x 90.55 Inch
Weight	136.69 lb	138.89 lb	262.35 lb

## PERFORMANCES

Max. welding current	14 000 A - (240 V)		14 000 A - (240 V)		14 500 A - (240 V)	
Weldable steels	Mild steel	HSS	AHSS	UHSS	Boron	
Max. pressure	550 daN (<120.381 PSI)		550 daN (<116 PSI)			
Max. weldable sheet thickness	0.098 + 0.098 + 0.098 Inch					

## CLAMP

Interconnection cable length	157.48 Inch		196.85 Inch (disconnectable)	
Clamp support and base plate	Brass			
Over-opening	—	mechanical, 2.95 Inch		
Compatible with arms	G9	—	✓	
	G11	✓	✓	
Integrated gyroscope on the clamp	—		✓	
Clamp weight	with G1 arm	21.38 lb	22.71 lb	26.01 lb

Non-contractual values



INVEST IN THE FUTURE



Made in France  
since 1964



**GYS FRANCE**

**HEAD OFFICE**

1 rue de la Croix des Landes  
CS 54159  
53941 Saint-Berthevin - Cedex  
Laval - France  
Tél +33 2 43 01 23 60  
E-mail service.client@gys.fr



**GYS FRANCE**

**LOGISTICS CENTRE**

2 Rue Jean Dausset  
53810 Changé - France  
Tél +33 2 43 01 54 33



**GYS GERMANY**

Professor-Wieler  
Straße 11  
52070 Aachen  
Deutschland  
Tél +49 241/189-23-710  
Fax +49 241/189-23-719  
E-mail aachen@gys.fr



**GYS UK**

Unit 3 - Great Central Way  
Rugby - Warwickshire  
CV21 3XH  
United Kingdom  
Tél +44 1926 338 609  
Fax +44 1926 429 764  
E-mail uk@gys.fr



**GYS ITALY**

Via Porta Est, 7  
30020 Marcon - VE  
Italia  
Tél +39 041 53 21 565  
E-mail italia@gys.fr



**GYS IBÉRICA**

Avenida Pirineos 31  
Nave 9  
San Sebastian de los Reyes  
28703 Madrid  
España  
Tél +34 917 409 790  
E-mail iberica@gys.fr



**GYS CHINA**

Lot N°15  
6666 bd Songze  
Qingpu201706  
Shanghai  
China  
Tél +86 6221 4461  
Fax +86 5226 0067  
www.gys-china.com.cn  
E-mail  
contact@gys-china.com.cn



 LinkedIn  
 Youtube  
 TikTok  
 Facebook  
 Instagram

www.gys.fr